



## WHITMORE AVENUE, HAROLD WOOD, ROMFORD

Freehold One Bedroom Starter Home | End Of Chain | Allocated Parking | Lounge | Kitchen | Bedroom | Bathroom | Own Rear Garden | Close To Local Shops and Amenities | Approximately 0.5 miles From Harold Wood Crossrail Elizabeth Line Railway Station |

**Offers Over £325,000** Freehold | 1 bedroom terraced house for sale

**SSTC**

CHARLES STRATTON  
ESTATE AGENTS





Tenure: Freehold  
Parking options: Off Street  
Garden details: Private Garden





Whitmore Avenue, RM3

Approximate Area = 488 sq ft / 45.3 sq m  
Outbuilding = 7 sq ft / 0.7 sq m  
Total = 495 sq ft / 46 sq m  
For identification only - Not to scale

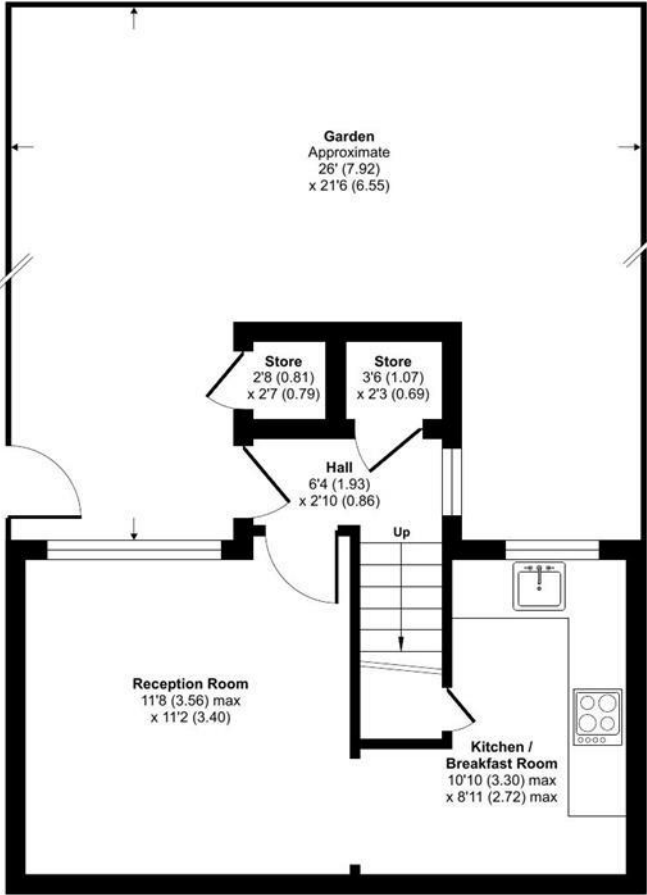

GROUND FLOOR

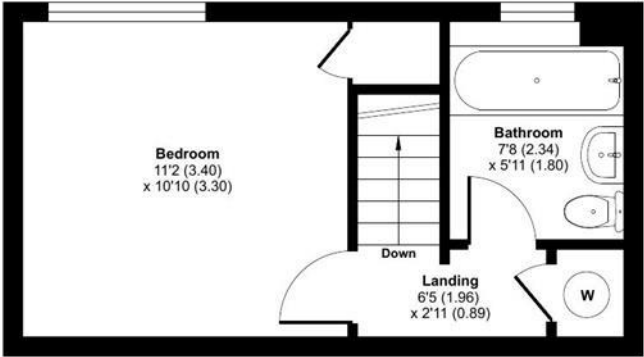

FIRST FLOOR



Floor plan produced in accordance with RICS Property Measurement Standards incorporating International Property Measurement Standards (IPMS2 Residential). © nitchecom 2024. Produced for Charles Stratton Estates Ltd. REF: 1192706

Energy Efficiency Rating		Environmental Impact (CO <sub>2</sub> ) Rating	
Very energy efficient - lower running costs	Current	Very environmentally friendly - lower CO <sub>2</sub> emissions	Current
A		A	88
B		B	
C		C	
D		D	
E		E	
F		F	
G		G	
Not energy efficient - higher running costs		Not environmentally friendly - higher CO <sub>2</sub> emissions	
England & Wales	EU Directive 2002/91/EC	England & Wales	EU Directive 2002/91/EC

The energy efficiency rating is a measure of the overall efficiency of a home. The higher the rating the more energy efficient the home is and the lower the fuel bills will be.

The environmental impact rating is a measure of a home's impact on the environment in terms of carbon dioxide (CO<sub>2</sub>).

Viewing by appointment only  
Charles Stratton Estates Ltd

192 Main Road, Gidea Park, Romford RM2 5HA

Tel: 01708 726 817 Email: [sales@charlesstratton.co.uk](mailto:sales@charlesstratton.co.uk) Website: [www.charlesstratton.co.uk/](http://www.charlesstratton.co.uk/)

Every care has been taken with the preparation of these particulars, but complete accuracy cannot be guaranteed. If there is any point, which is of particular importance to you, please obtain professional confirmation. Alternatively, we will be pleased to check the information for you. These Particulars do not constitute a contract or part of a contract. The Fixtures, Fittings & Appliances have not been tested and therefore no guarantee can be given that they are in working order. Photographs are reproduced for general information and it cannot be inferred that any item shown is included in the sale. For any information regarding broadband and mobile phone signals go to OfCom via this link - <https://checker.ofcom.org.uk/>